

# LIGHTING SYSTEM

## PRECAUTION

### 1. DISCONNECT AND RECONNECT CABLE OF NEGATIVE BATTERY TERMINAL

#### NOTICE:

When disconnecting the cable from the negative (-) battery terminal, initialize the following systems after the cable is reconnected.

System Name	See procedure
METER / GAUGE SYSTEM	See page <a href="#">ME-10</a>

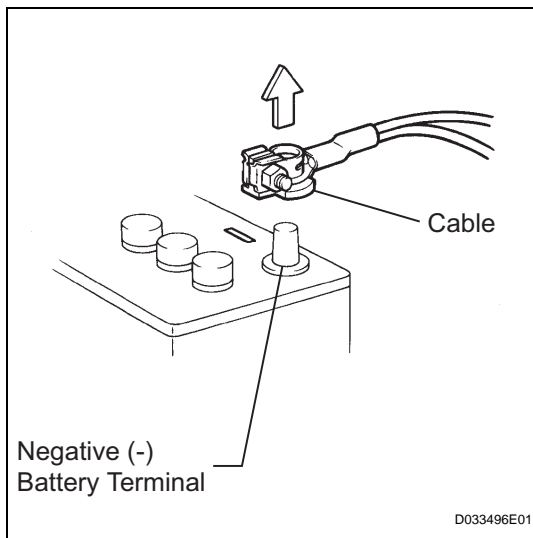

- Before performing electronic work, disconnect the cable from the negative (-) battery terminal in order to prevent it from shorting and burning out.
- Before disconnecting and reconnecting the battery cable, turn the ignition switch OFF and the headlight dimmer switch OFF. Then loosen the terminal nut completely. Do not damage the cable or terminal.
- When the battery cable is disconnected, the clock and radio settings and stored DTCs are erased. Therefore, before disconnecting the battery cable, make a notes of them.

## PARTS LOCATION

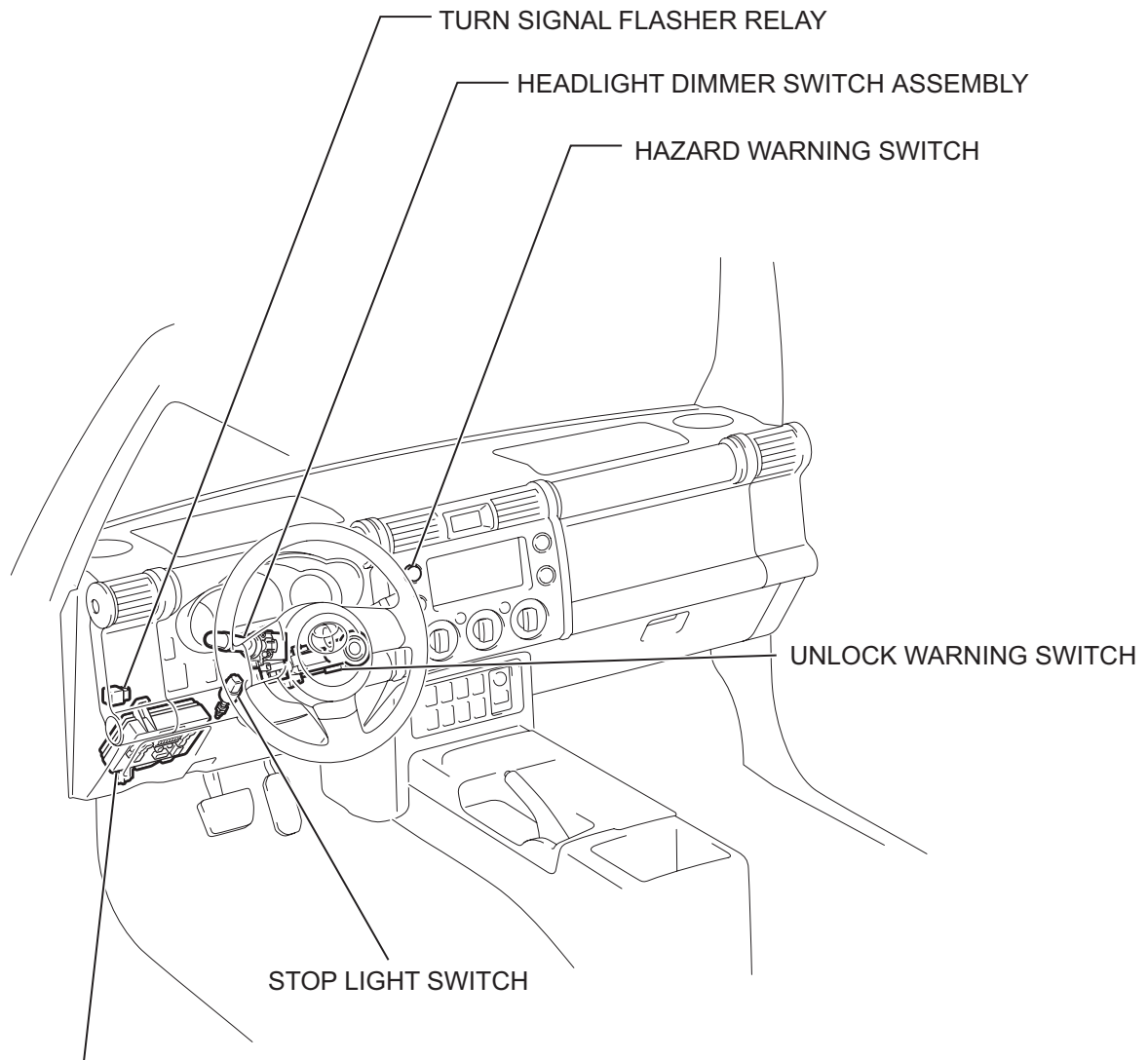

MAIN BODY ECU (DRIVER SIDE J/B)

- TAIL RELAY
- TAIL FUSE
- GAUGE FUSE
- IG1 FUSE

REAR DOOR LOCK ASSEMBLY RH (UPPER)

- REAR DOOR COURTESY SWITCH

FRONT DOOR COURTESY SWITCH  
(PASSENGER SIDE)

REAR DOOR LOCK ASSEMBLY LH (UPPER)

- REAR DOOR COURTESY SWITCH

**FOR A/T:**

PARK / NEUTRAL POSITION  
SWITCH

FRONT DOOR COURTESY SWITCH  
(DRIVER SIDE)

REAR DOOR LOCK ASSEMBLY LH (LOWER)

- REAR DOOR COURTESY SWITCH

REAR COMBINATION LIGHT LH

REAR DOOR LOCK ASSEMBLY  
RH (LOWER)

- REAR DOOR COURTESY  
SWITCH

HIGH MOUNTED STOP  
LIGHT

BACK DOOR COURTESY  
SWITCH

REAR COMBINATION  
LIGHT RH

LICENSE PLATE LIGHT

BACK WINDOW LOCK ASSEMBLY

- BACK WINDOW COURTESY SWITCH

**FOR M/T:**

BACK-UP SWITCH

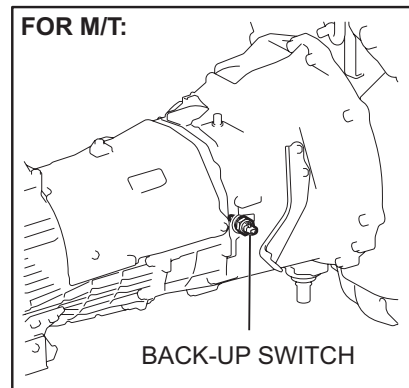
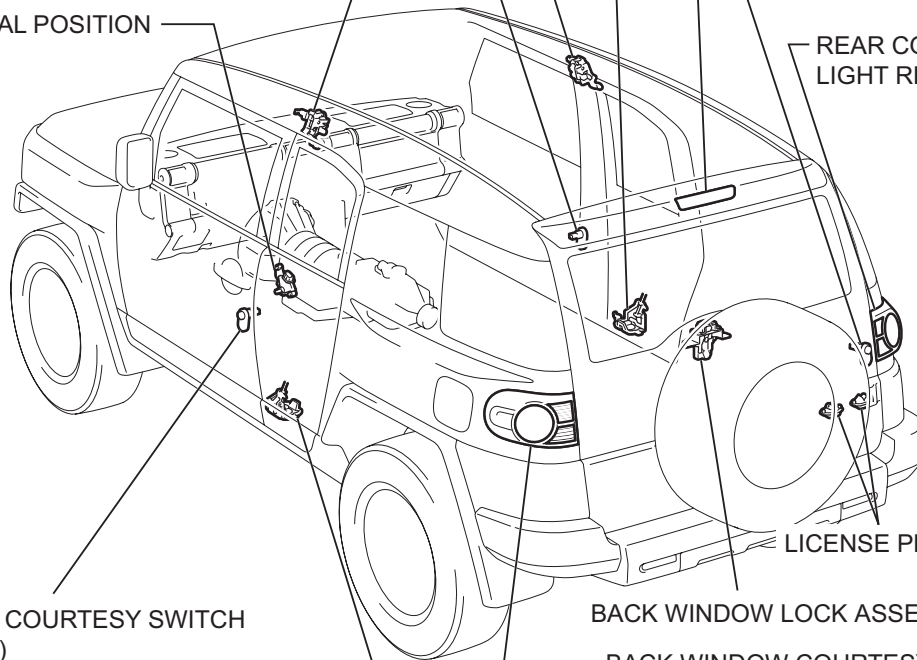

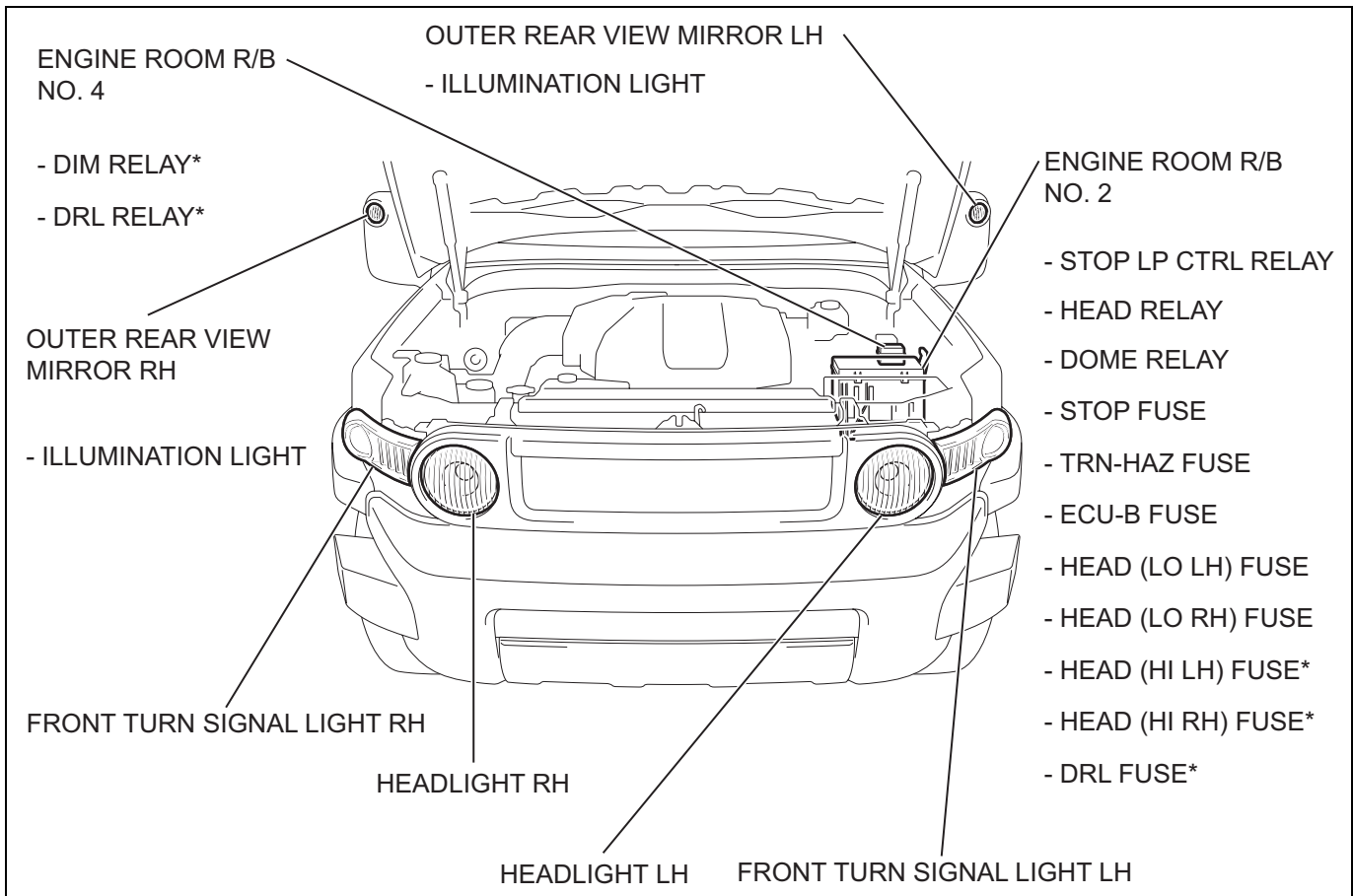

\*: W/ DAY TIME RUNNING LIGHT SYSEM

